

BRICK ARC

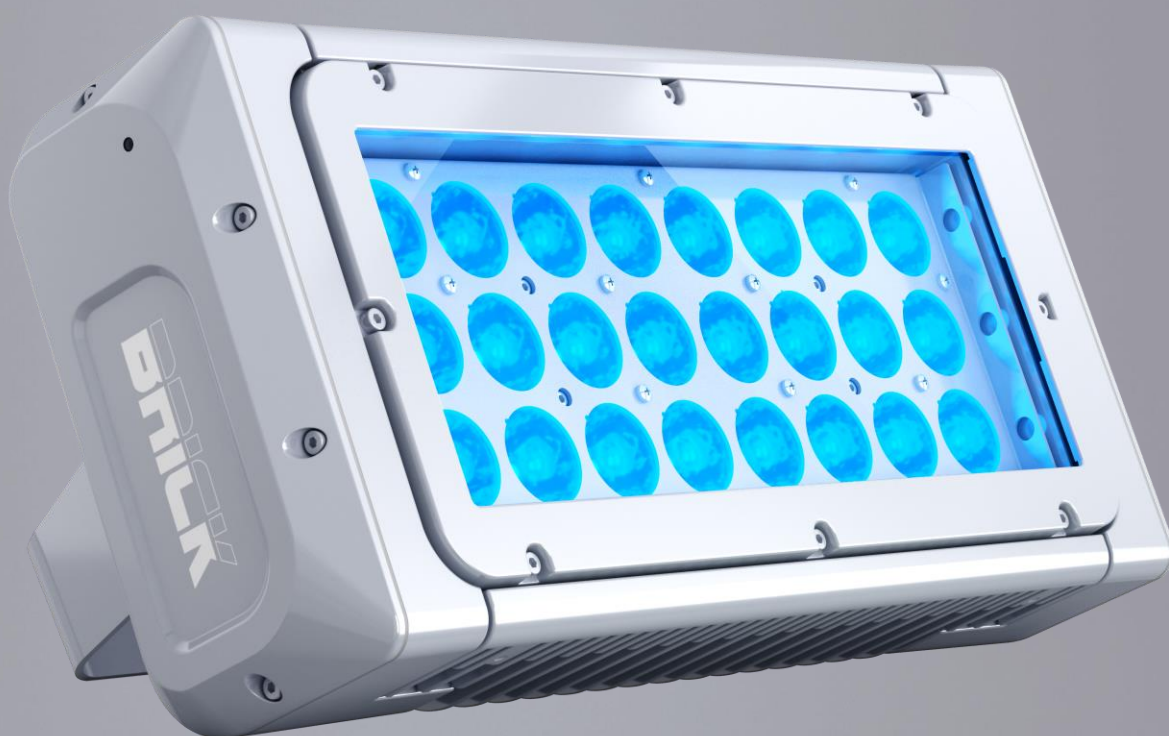

USER'S MANUAL rel. 1.0 GB

CE

Le informazioni contenute in questo documento sono state attentamente redatte e controllate. Tuttavia non è assunta alcuna responsabilità per eventuali inesattezze. Tutti i diritti sono riservati e questo documento non può essere copiato, fotocopiato, riprodotto per intero o in parte senza previo consenso scritto della D.T.S.

D.T.S. si riserva il diritto di apportare senza preavviso cambiamenti e modifiche estetiche, funzionali o di design a ciascun proprio prodotto. D.T.S. non assume alcuna responsabilità sull'uso o sull'applicazione dei prodotti o dei circuiti descritti.

The information contained in this publication has been carefully prepared and checked. However, no responsibility will be taken for any errors. All rights are reserved and this document cannot be copied, photocopied or reproduced, in part or completely, without prior written consent from D.T.S.

D.T.S. reserves the right to make any aesthetic, functional or design modifications to any of its products without prior notice. D.T.S. assumes no responsibility for the use or application of the products or circuits described herein.

Les informations contenues dans le présent manuel ont été rédigées et contrôlées avec le plus grand soin. Nous déclinons toutefois toute responsabilité en cas d'éventuelles inexactitudes. Tous droits réservés. Ce document ne peut être copié, photocopié ou reproduit, dans sa totalité ou partiellement, sans le consentement préalable de D.T.S.

D.T.S. se réserve le droit d'apporter toutes modifications et améliorations esthétiques, fonctionnelles ou de design, sans préavis, à chacun de ses produits. D.T.S. décline toute responsabilité sur l'utilisation ou sur l'application des produits ou des circuits décrits.

Las informaciones contenidas en este documento han sido cuidadosamente redactadas y controladas. Con todo, no se asume ninguna responsabilidad por eventuales inexactitudes. Todos los derechos han sido reservados y este documento no puede ser copiado, fotocopiado o reproducido, total o parcialmente, sin previa autorización escrita de D.T.S.

D.T.S. se reserva el derecho a aportar sin previo aviso cambios y modificaciones de carácter estético, funcional o de diseño a cada producto suyo. D.T.S. no se asume responsabilidad de ningún tipo sobre la utilización o sobre la aplicación de los productos o de los circuitos descritos.

INDEX:

1- SYMBOLS	4
2- GENERAL WARNING	5
3- GENERAL WARRANTY CONDITIONS	5
4- TECHNICAL FEATURES	5
5- ACCESSORIES	6
6- IMPORTANT SAFETY INFORMATION	7
6.1 Fire prevention	7
6.2 Prevention of electric shock	7
6.3 Safety	7
6.4 Level of protection against the penetration of solid and liquid objects	7
6.5 Waste Electrical and Electronic Equipment (WEEE) directive	7
7- INSTALLATION	8
8- CONNECTIONS	9
9- HOLOGRAPHIC FILTER INSTALLATION	10
10- LENSES SET REPLACEMENT	11
11- VISOR INSTALLATION	12
12- WIRING DIAGRAMS	13

1- SYMBOLS

Graphic symbols used on this manual:



THIS SYMBOL INDICATES A HOT SURFACE



THIS SYMBOL INDICATES ELECTRIC SHOCK RISK



THIS SYMBOL INDICATES GENERAL RISK

t_a 40°C

THIS SYMBOL INDICATES THE MAXIMUM OPERATING AMBIENT TEMPERATURE

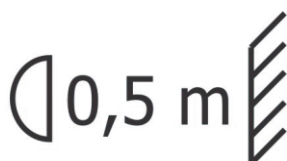

THIS SYMBOL INDICATES THE MINIMUM DISTANCE FROM THE ILLUMINATED OBJECTS



THIS SYMBOL MEANS “DO NOT STARE AT THE OPERATING LIGHT SOURCE”



Risk Group 2

THIS SYMBOL INDICATES PHOTOBIOLOGICAL SAFETY



THIS SYMBOL INDICATES THE EUROPEAN COMMUNITY DIRECTIVE 2012/19/EC ON WASTE ELECTRICAL AND ELECTRONIC EQUIPMENT (WEEE)

2- GENERAL WARNING

Read the instruction contained in this user manual carefully, as they give important information regarding safety during installation, use and maintenance.

The unit is not for household use and must be installed by a qualified electrician or experienced person.

Always disconnect the device from the mains before maintenance.

The device must always be equipped with an efficient ground connection.

3- GENERAL WARRANTY CONDITIONS

The unit is guaranteed for 36 months from the date of purchase against manufacturing material defects.

4- TECHNICAL FEATURES

DTS product codes:

03.LDB104E28FC08	BRICK ARC FC UN lenses RAL 9006 ACC finishing
03.LDB104E28FC10	BRICK ARC FC SP lenses RAL 9006 ACC finishing
03.LDB104E28FC25	BRICK ARC FC MF lenses RAL 9006 ACC finishing
03.LDB104E28FC40	BRICK ARC FC WF lenses RAL 9006 ACC finishing

Output

24 OSTAR STAGE "N" Full Color (RGBW) LEDs
LED lifespan: 50.000 hours (70% lumen output)

Optical group

4 lenses set available:

- Ultra-Narrow 8°
- Narrow 12°
- Medium 28°
- Wide 38°

Uniform projection on surfaces

Color generation

16 million colors

Wide palette of pure uniform Whites with variable linear color temperature (2700K-8000K)

Power supply

External PSU:

- DRIVENET 416 POWER (full-range 100-240Vac 50-60 Hz)
- DRIVENET 832 POWER (range 180-240Vac 50-60 Hz)*

* the maximum current for all outputs must be set to 1400mA

Power consumption: 240W max

Connections

LED IN: 0,7 m cable with M16 male IP67 connector

Operating ambient temperature

-30° / 40°C

Physical

IP65

IK protection degree: IK09

Weight: 9 Kg

Finishing: RAL 9006 + ACC treatment which guarantees effective protection against corrosion

Certifications



DIMENSIONS

REAR VIEW

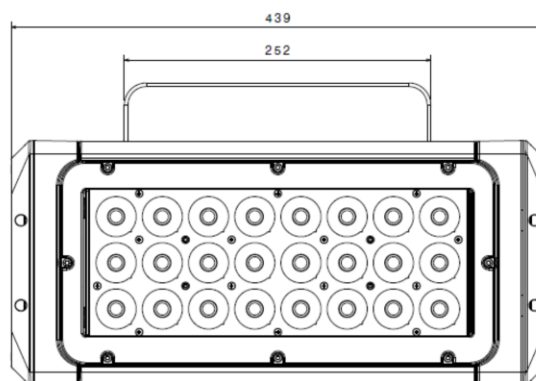
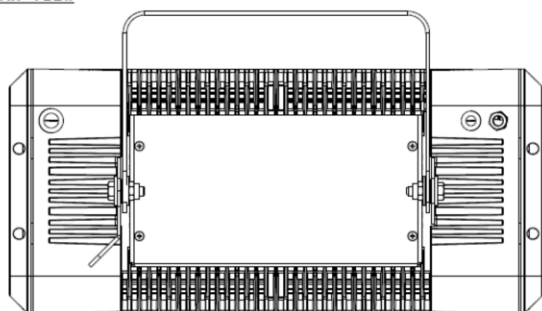

TILT RANGE

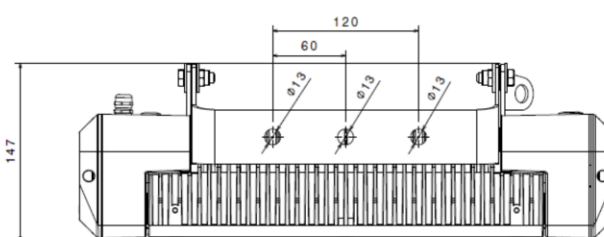
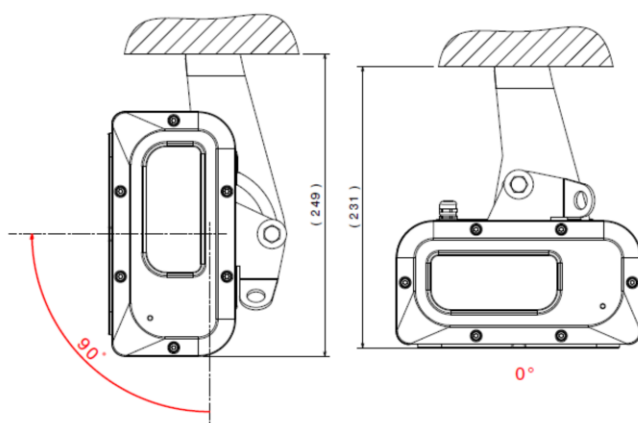

5- ACCESSORIES

As standard

- 1 x M16 female IP67 cable connector (code 0508B106)
- 1 x User's Manual

Optional (on request)

- Lenses set Ultra-Narrow 8° (code 03.LK.273.44)
- Lenses set Narrow 12° (code 03.LK.274.44)
- Lenses set Medium 28° (code 03.LK.275.44)
- Lenses set Wide 38° (code 03.LK.276.44)
- Holographic filter 10° (code 0506A101.D11)
- Holographic filter 20° (code 0506A043.D11)
- Holographic filter 40° (code 0506A045.D11)
- Holographic filter 60° (code 0506A103.D11)
- Holographic filter 80° (code 0506A121.D11)
- Holographic filter 60°x10° (code 0506A092.D11)
- Holographic filter 60°x30° (code 0506A119.D11)
- Holographic filter 30°x60° (code 0506A133.D11)
- Visor RAL 9006 ACC finishing (code 03.LA.229.28)
- Aliscaf clamp for tube diameter 50 mm (Max load 200 Kg) (code 0521A033)
- (indicated for any kind of loads vertical / horizontal)
- G60 "C" Clamp (Max load 50 Kg) (code 0521A004) (not indicated for horizontal load)
- Safety cable 3 x 600 mm (Max load 60 Kg) (code 0521A010)

6- IMPORTANT SAFETY INFORMATION

6.1 Fire prevention:

-Minimum distance from the closest illuminable surface: 0,5 m.

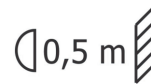

6.2 Prevention of electric shock:



-High voltage is present inside the unit. Unplug the unit prior to performing any function which involves touching the inside of the projector.

-The level of technology inherent in the BRICK ARC requires the assistance of specialised personnel for all servicing.

Please refer to an authorised DTS service centre.

-The fixture should be located in places with a good air ventilation.

6.3 Safety:



-Risk Group 2 product according to EN 62471.



Risk Group 2

CAUTION. Do not look directly into the light output. May be harmful to the eyes and skin.

-Do not stare at the operating light source.



-The light source contained in this luminaire shall only be replaced by the manufacturer or his service agent or a similar qualified person.

-The unit is not for household use and must be installed by a qualified electrician or experienced person.

-The projector should always be installed with bolts, clamps and other tools that are capable of supporting the weight of the unit.

-Always use a second safety cable to sustain the weight of the unit in case of the failure of the main fixing point.

-The external surface of the unit, at various points, may exceed 60°C. Never handle the unit until at least 5 minutes have elapsed since the projector was turned off.

-Never install the fixture in an enclosed area lacking sufficient air flow.



The ambient temperature should not exceed 40°C. t_a 40°C

6.4 Level of protection against the penetration of solid and liquid objects:



-The projector is classified as an outdoor appliance and its protection level against the penetration of solid and liquid objects is IP65.

Suitable for wet locations.

6.5 Waste Electrical and Electronic equipment (WEEE) directive:



-The machine, accessories and packaging should be sorted for environmental-friendly Recycling.

For EC countries: according to the European Directive 2012/19/EC for Waste Electrical and Electronic Equipment and its implementation into national right, luminaires that are no longer usable must be collected separately and disposed of in an environmentally correct manner.

7- INSTALLATION

The unit is suitable for wet locations.

BRICK ARC can be installed on a truss or on the ceiling.

It is recommended the use of appropriate clamps to fix the unit to the mounting surface.

The supporting structure from which the unit is hung should be capable of bearing the weight of the unit, as should any clamps used to hang it.

Fixing clamps are available on demand.

ATTENTION:

A safety cable must be securely fixed to the unit's mounting bracket and to the support structure of the projector as shown in the picture.

A suitable safety cable (code 0521A038) is available on demand.

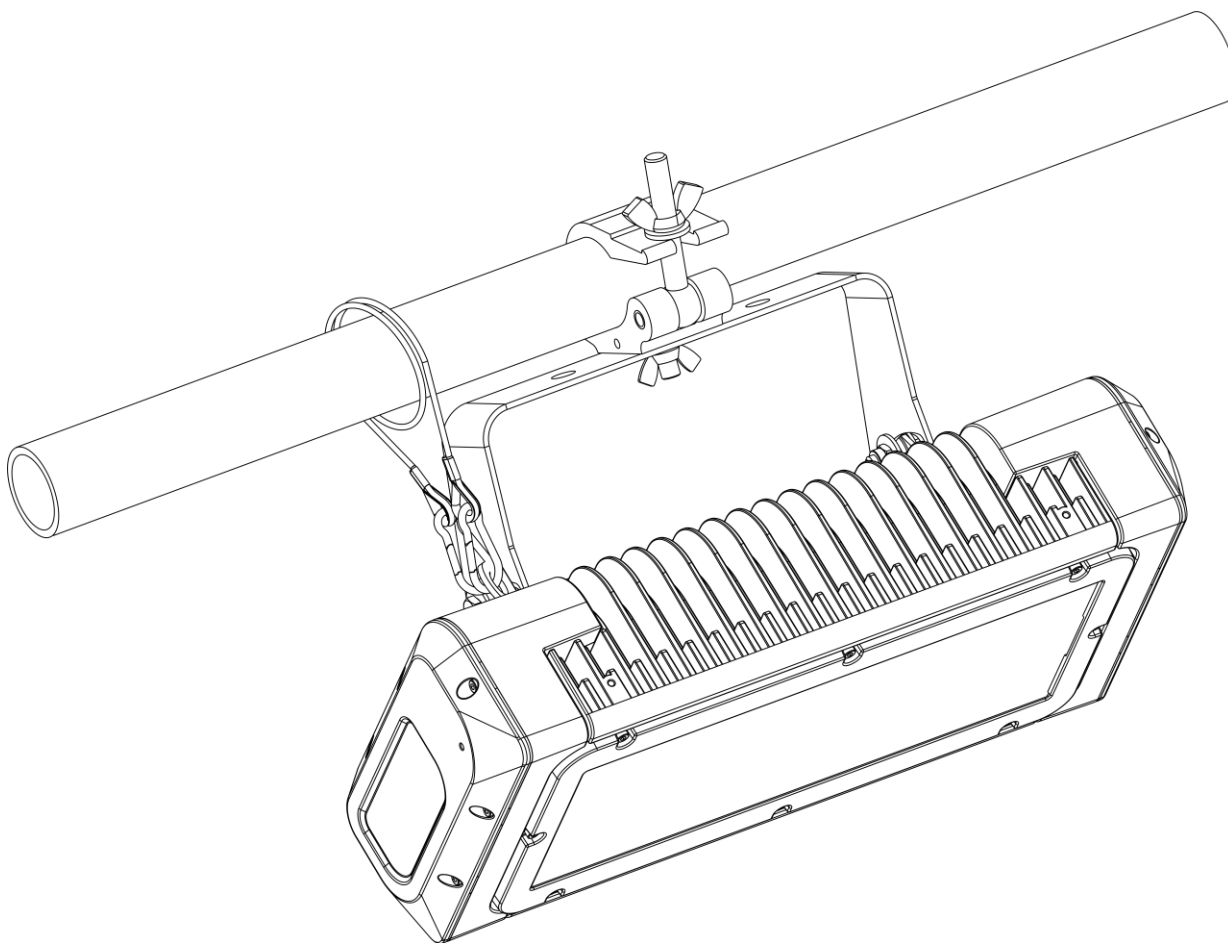

8- CONNECTIONS

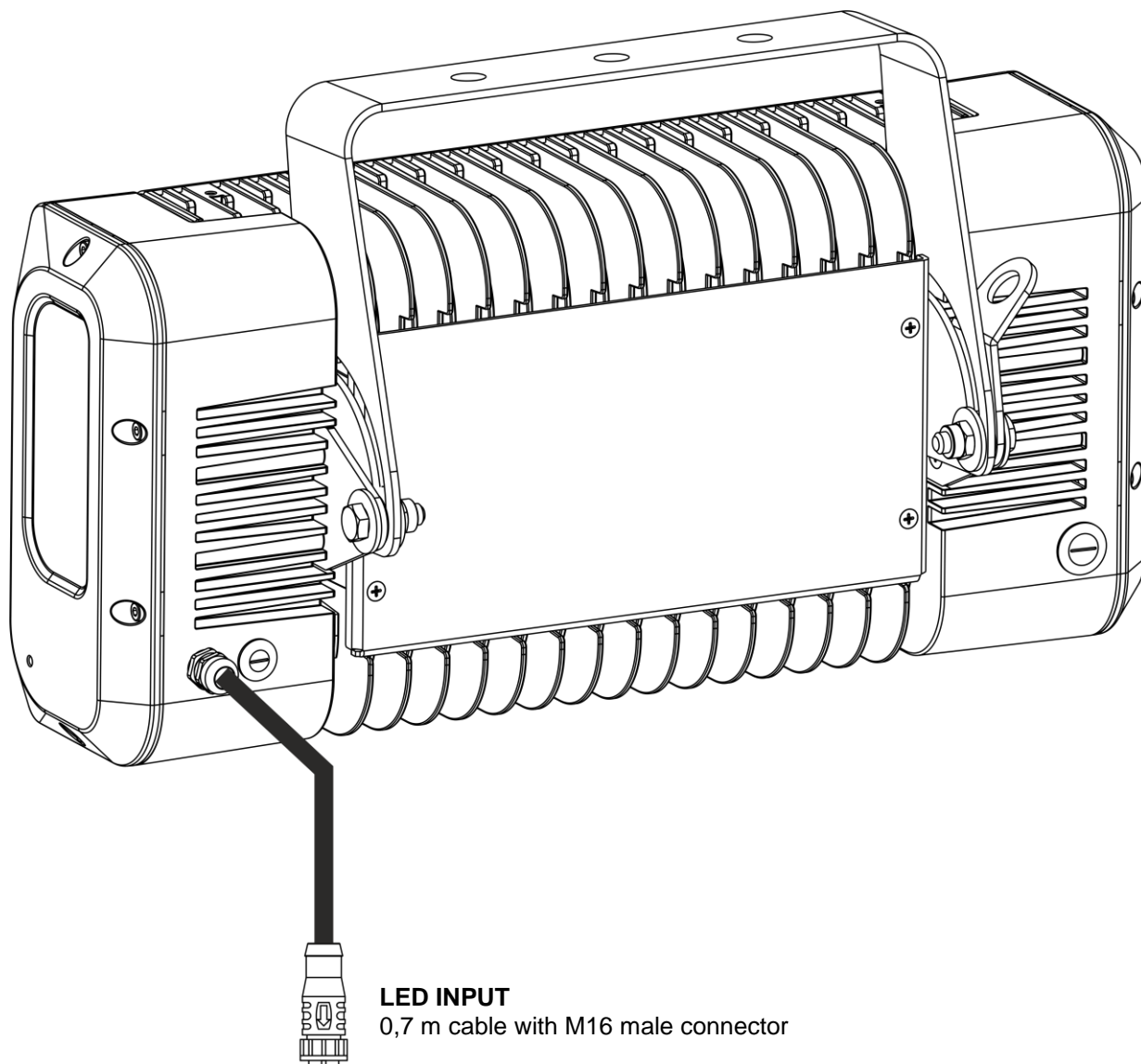

9- HOLOGRAPHIC FILTER INSTALLATION

Attention: the holographic filter installation must be made by DTS personnel or experienced person.

Wrong operations can damage the IP65 protection.

- 1 - Remove the front screen with the protection glass by loosening the 8 marked screws.
- 2 - Put in place the holographic filter by keeping its microstructure side inward.

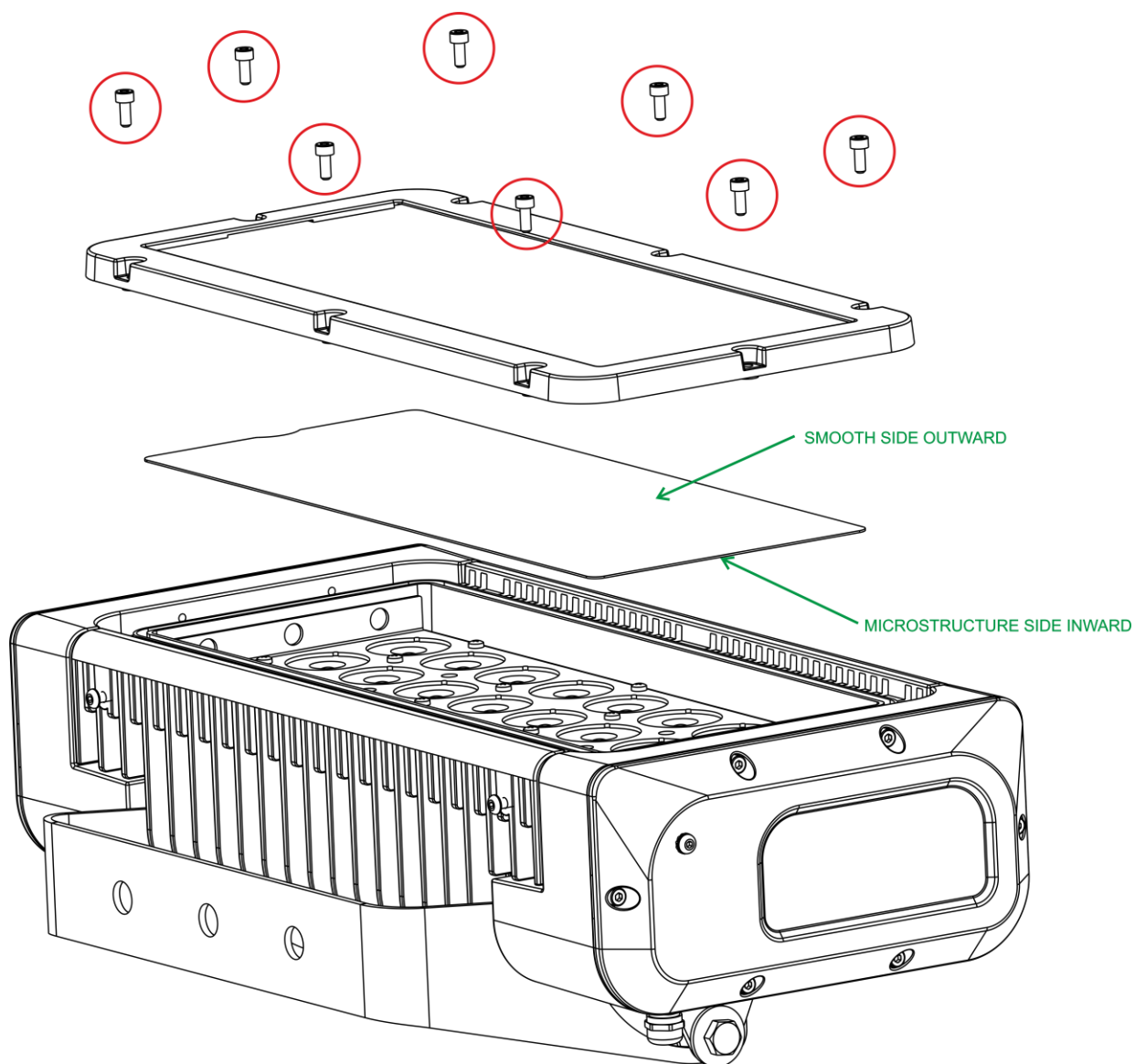

10- LENSES SET REPLACEMENT

Attention: the lenses set replacement must be made by DTS personnel or experienced person.

Wrong operations can damage the IP65 protection.

1 - Remove the front screen with the protection glass by loosening the 8 marked screws.

2 - Remove the original lenses set by loosening the 4 marked screws.

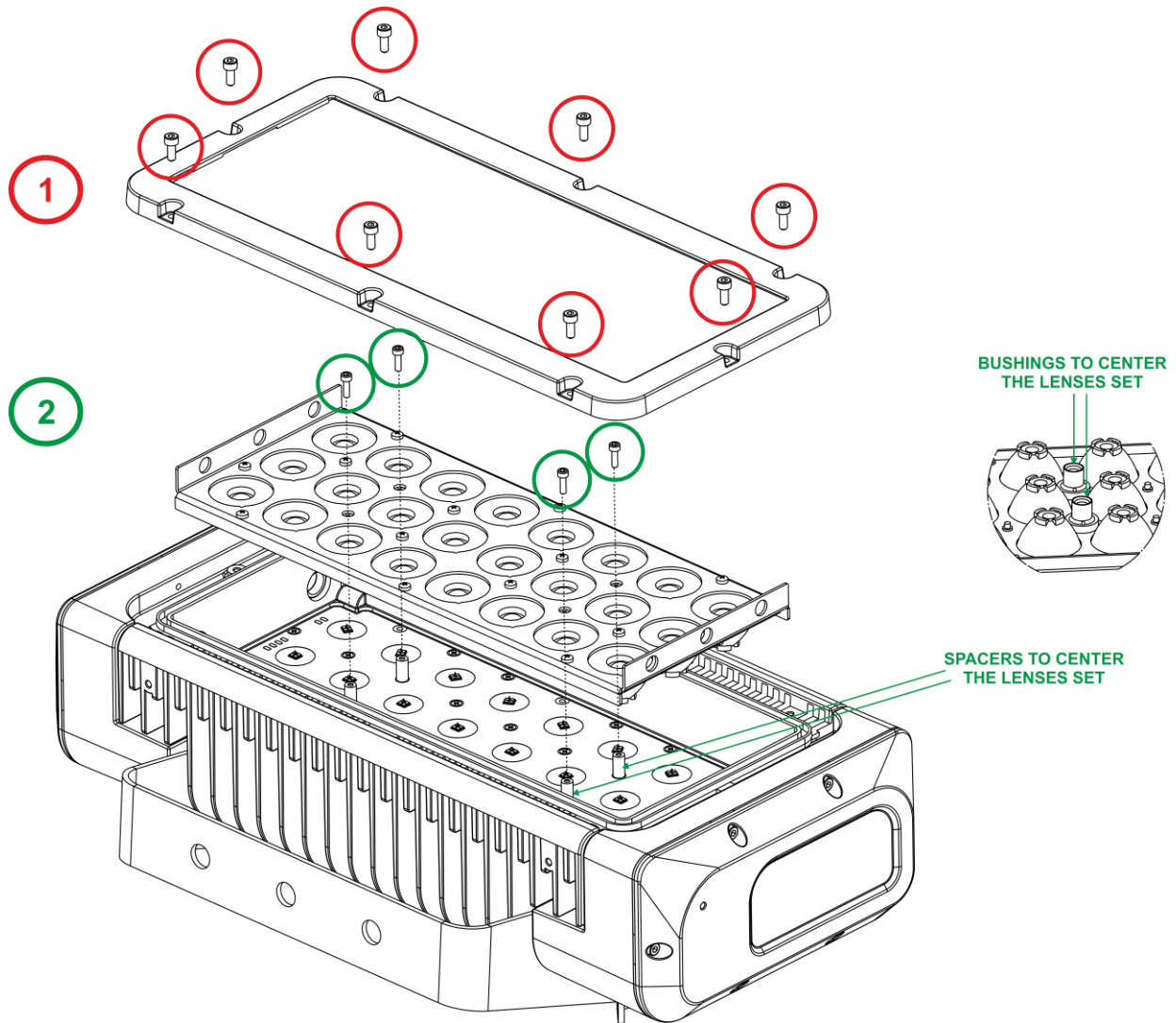

11- VISOR INSTALLATION

The Visor for BRICK ARC (code 03.LA.229.28) is available on demand.

Fix the Visor on the BRICK ARC by using the 4 marked screws previously removed from the unit body.

Once installed, fix the safety cable on the side cap by using the marked screw and the washer provided in the box.

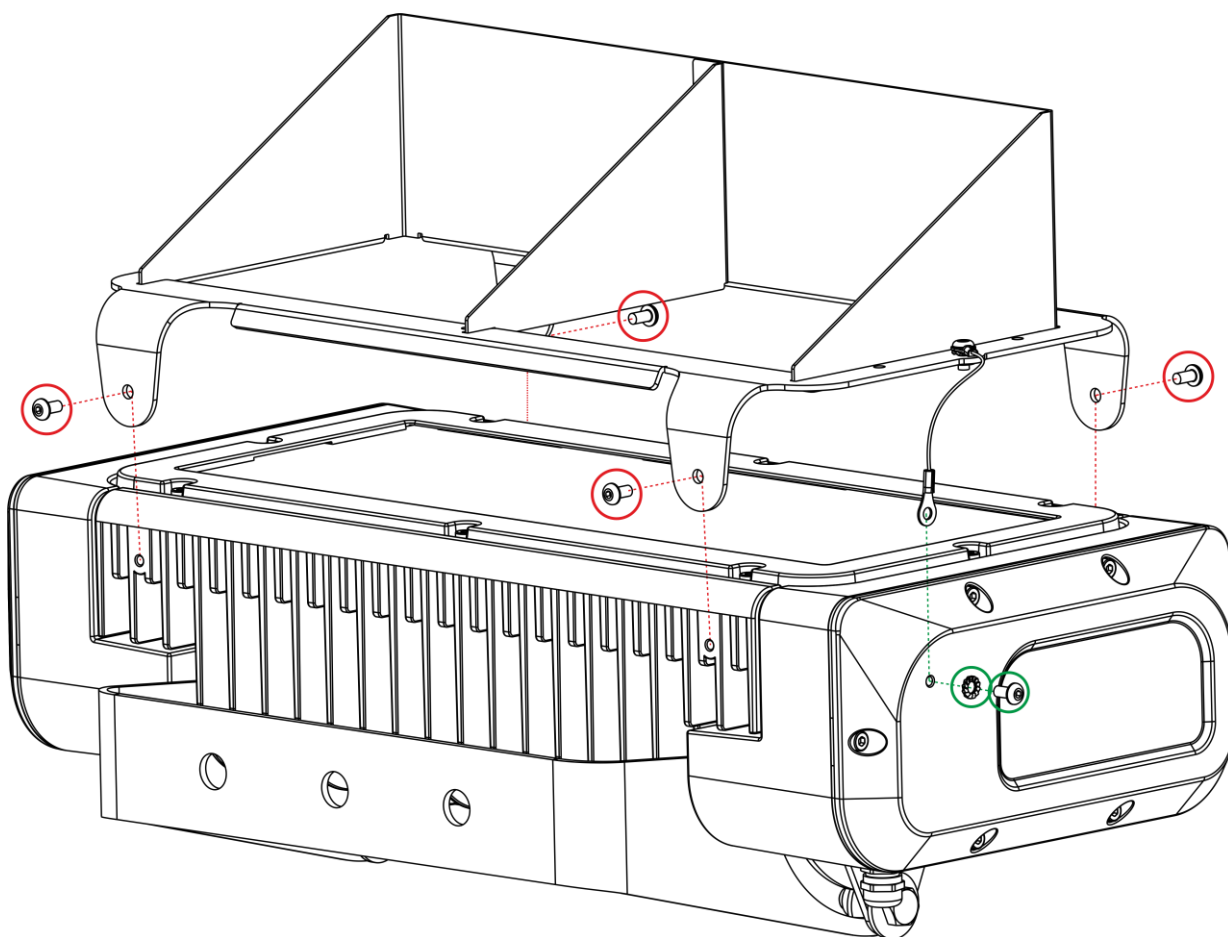

12- WIRING DIAGRAMS

The maximum number of BRICK ARC connectable to each output of DRIVENET 416 or 832 POWER is 1 piece.

The maximum distance between DRIVENET POWER and the unit should not exceed 50 meters.

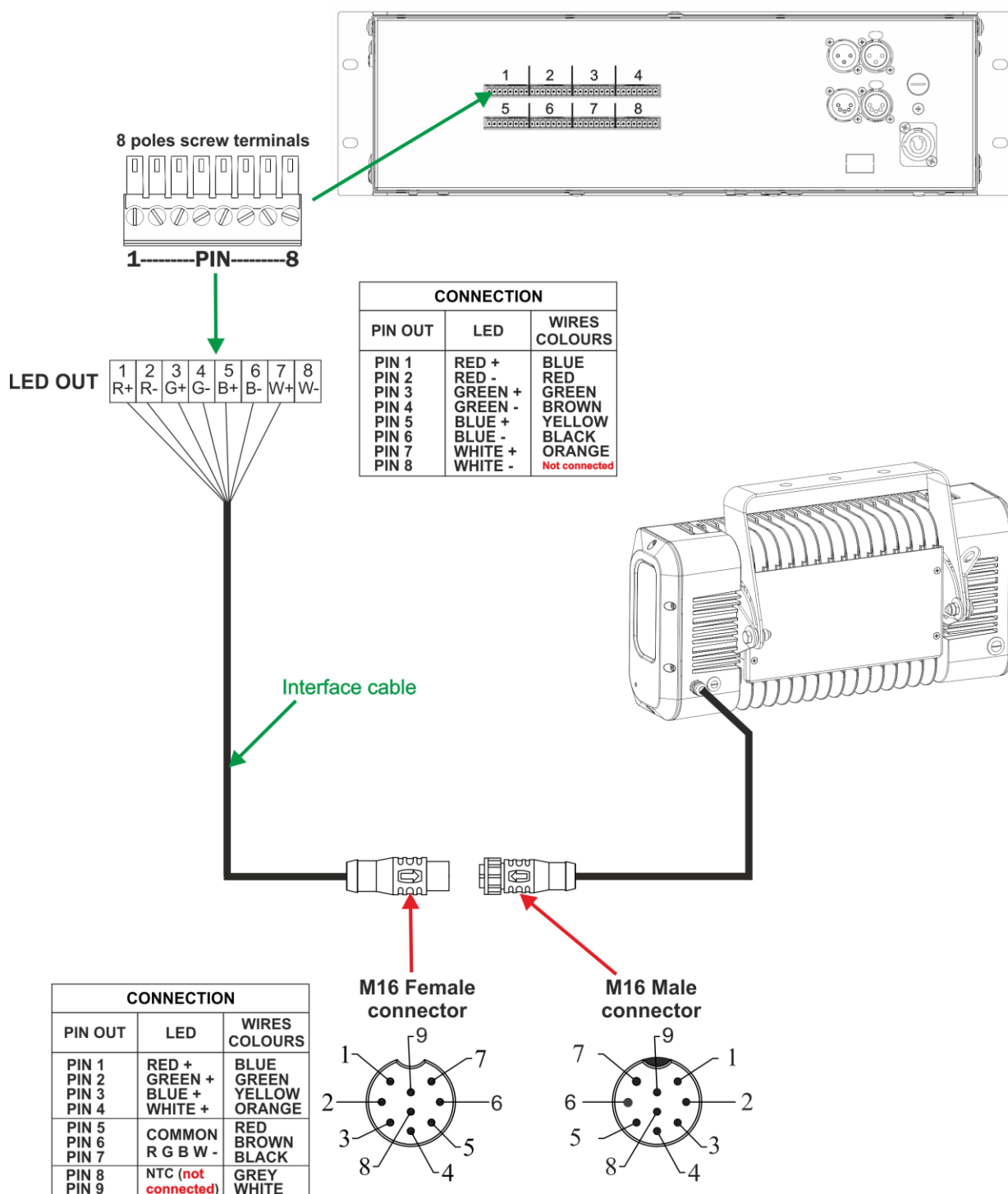
DRIVENET 832 POWER (code 03.LA.184)

NOTES

NOTES

ISO 9001:2015

DTS quality system is
certified to the ISO
9001:2015 standard



05171321



**MADE IN
ITALY**

D.T.S. Illuminazione s.r.l.

Via Fagnano Selve 12- • 47843 Misano Adriatico (RN) Italy
Tel.: +39 0541 611131 • Fax +39 0541 611111 info@dts-lighting.it

www.dts-lighting.it